

EMERGENCY ASSIST ALARM - STAND ALONE KIT



PRODUCT CODE
DTA-6000

FEATURES

- Complies with regulations & recommendations
- Dual loop pull cord
- High contrast labels
- Blue indication

DESCRIPTION

The Emergency Assist Alarm - stand alone kit provides the perfect solution for conformity with the Building Regulations Document M and Equality Act 2010.

This is a simple 2 wire system that has been specifically designed to meet the needs of disabled service users and conforms to all the relevant requirements; Disability Rights Commission code of practice, English Tourism Council Recommendations and RNIB signage guidelines.

The use of combined high output blue LED indication and buzzer ensures a response to the call.

The Emergency Assist Alarm - stand alone kit comprises of all the components needed to install a fully compliant system, with additional parts available separately.

BENEFITS

- Quick and simple installation, with limited cabling requirements.
- High contrast printing for increased visibility.
- Tactile Braille signage to assist partially sighted people to easily operate the cancel plate.
- Additional plate can be added to give system flexibility.



EMERGENCY ASSIST ALARM - STAND ALONE KIT

SYSTEM INSTALLATION

The Emergency Assist Alarm should be installed in accordance with the recommendations of BS8300 and to the requirements of Building Regulations Approved Document M. The diagram below demonstrates a typical layout for installation in a disabled person toilet.

Note: Where pertinent other or alternative standards of design and installation should be adhered to.

All system components are designed to be sited internally and positioned in locations where they are readily accessible by the user. The area should be clean and dry. Sound and light levels allow the status of all device indicators and sounders to be seen and heard.

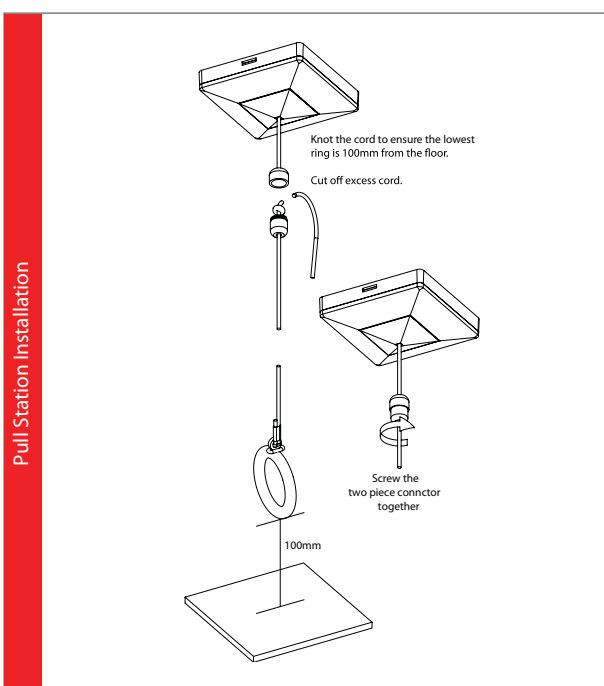
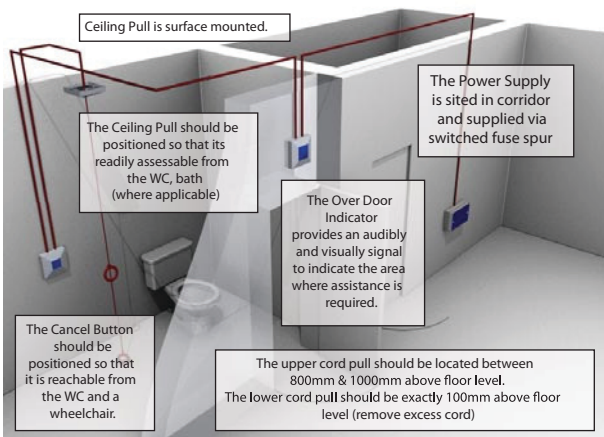

MAINS WIRING

The general requirement for the mains supply to the call controller is fixed wiring, using three core cable of not less than 1mm². This should be fed from an isolating switched fused spur, fused at 3A, which is marked appropriately and secure from unauthorised operation.

All mains wiring should be provided in accordance with the current edition of the IEE Wiring Regulations (BS 7671) or in accordance with the relevant national wiring rules.

EXTRA LOW VOLTAGE (ELV) WIRING

Always segregate low voltage wiring from the mains wiring. System requires minimum 2 core 0.4mm² cable. All wall-mounting devices should be mounted onto a back box of the required depth.

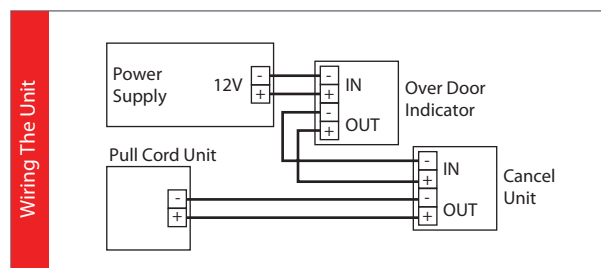

OUT	IN
PSU Unit	Over Door Indicator
Over Door Indicator	Cancel Unit
Cancel Unit	Pull Cord Unit

SYSTEM OPERATION

Normal State	Power Supply Unit power LED is lit.
To Place a Call	Operate the Pull Cord. LED's will illuminate on, Pull Cord Unit, Cancel Unit and Over Door Indicator. An internal buzzer will also sound in the Over Door Indicator.
To Reset Call	Press the Cancel Button.

Product Code	Product Description
DTA-6000	Emergency Assist Alarm - Stand Alone Kit (1x Power Supply Unit, 1x Over Door Indicator, 1x Cancel Button, 1x Pull Cord Unit, 1x Disabled Sticker)
Individual Emergency Assist Alarm Components	
DTA-6001	Emergency Assist Alarm Power Supply
DTA-6002	Emergency Assist Alarm Cancel Button
DTA-6003	Emergency Assist Alarm Pull Cord Unit
DTA-6004	Emergency Assist Alarm Over Door Indicator
DTA-6005	Emergency Assist Alarm Disabled Sticker (pack of 5)

Specifications are subject to change without notice